

# AUDITOR RSB-300

Subwoofer (12")



- Polypropylene cone
- Steel basket
- 4 Ω dual voice coil

## SPECIFICATIONS

Nominal power	300W RMS	
Maximum power	600W	
Sensitivity (2,83V/1m)	90dB	
Cone type	Polypropylene	
Surround type	Butyl	
Nom. impedance	4Ω + 4Ω	
DC resistance	3.2Ω + 3.2Ω	
VC diameter	50mm	2"
Net weight	4300g	9.48lbs

## FREQUENCY RESPONSE/IMPEDANCE

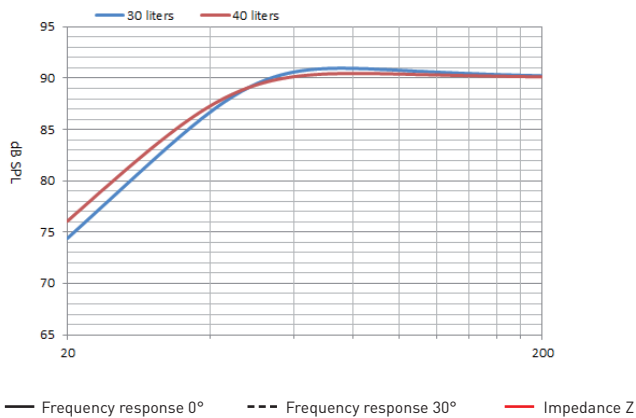

## PARAMETERS

Fs	25Hz
Vas	93l
Qts	0.47
Qes	0.52
Qms	4.5
Re	3.2Ω + 3.2Ω
Sd	471cm <sup>2</sup>
Cms	0.3mm/N
Mms	130g
Bl	8.3 N/A

## MECHANICAL DRAWING

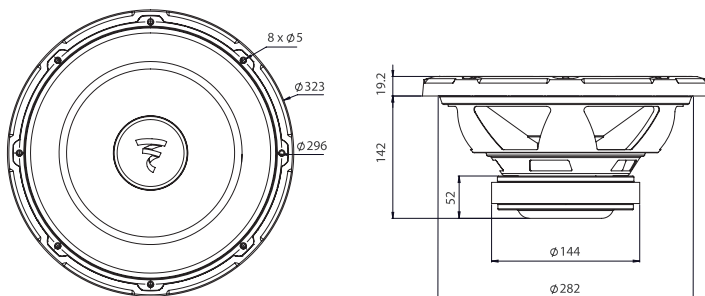

**Performance**  
CREATE YOUR SOUND

**FOCAL**